

Back to the Building.

Protocols for restarting in-person worship.

SUNDAY MORNING WORSHIP:

We will begin in-person Sunday morning worship on May 24th at 10:25am. If we reach 25% capacity for our building, we will offer two morning services, times to be announced. We will also be conducting a shorter communion-only service at 5:00pm with a limit of 50 people. You will need to register online each week to commit to attending in person. We will continue to livestream one of the services, and we strongly encourage the at-risk population to continue to participate in the livestream service and to not attend in person for the time being. The at-risk population are those who are:

- **AGE 65+, ESPECIALLY THOSE WITH CHRONIC LUNG DISEASE**
- **MODERATE TO SEVERE ASTHMA**
- **CHRONIC HEART DISEASE**
- **SEVERE OBESITY**
- **DIABETES**
- **CHRONIC KIDNEY DISEASE UNDERGOING DIALYSIS**
- **LIVER DISEASE**
- **WEAKENED IMMUNE SYSTEM**

By attending the in person worship, you are representing to all other attendees that you and every person in your household:

1.) Does not have known close contact with a person who is confirmed or suspected to have COVID-19

2.) Does not have any of the following new or worsening signs or symptoms of possible COVID-19: *Cough, Shortness of breath or difficulty breathing, Chills, Repeated shaking with chills, Muscle pain, Headache, Sore throat, Loss of taste or smell, Diarrhea, Feeling feverish or a measured temperature greater than or equal to 100.0 degrees Fahrenheit.*



- All attendees will wear a face mask except for attendees two years old and under. If you do not have a face mask, please let us know and WPC will provide one for you. No one will be allowed entrance without a face mask except for those leading worship while on the stage.

- Please maintain at least 6 feet separation from individuals that are not in your household.

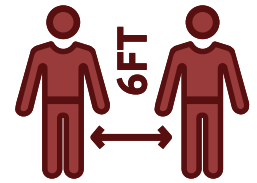

- Please greet each other with bows and waves rather than handshakes or other physical contact.



NURSERY

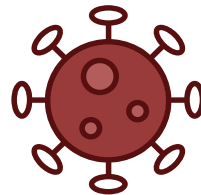

We will not have nursery available for at least the months of May and June. We know this is an inconvenience, but we are unable to protect against widespread exposure without this precaution.

SUNDAY SCHOOL

We will not have in person Sunday School for adults or children for at least the months of May and June. We will continue to have an online Zoom Sunday School available for the foreseeable future.

PARKING + BUILDING ENTRY

Two parking lots will be open. The South parking lot that is next to the Sanctuary, and the Bryan High parking lot.

Two entrances to the building will be available. If you park in the South parking lot, you will enter the Sanctuary in the marked entrance that is nearest to the front of the Sanctuary (near the upright piano).

If you park in the Bryan High parking lot, you will enter the marked entrance that is nearest to the front of the Sanctuary (near the choir room and the baby grand piano). If you enter from the Bryan High parking lot, you will need to proceed around the playground area. A map will be provided. The entrances will be propped open so that you will not have to touch door handles.

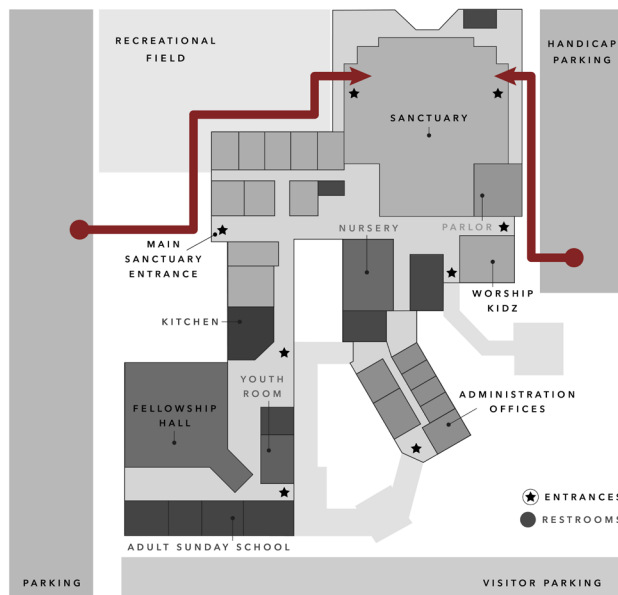

All other entrances to the building will remain closed. The foyer and hallways will be closed other than for a bathroom emergency. Please do not enter any other areas of the building.

Hand sanitizer will be available at entrances. Please have all household members sanitize their hands prior to sitting down.

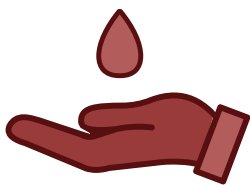

WORSHIP EXPERIENCE

Seating will be assigned by ushers as you enter the sanctuary. We will pre-assign seating based on online registration in advance of Sunday, but will have plenty of seating for those that cannot sign up in advance. All members of one household will be seated together, and we will make sure to maintain proper distancing between groups.

- Facemasks will be worn during the service except when taking communion. Instructions will be given during the service about when to remove your mask and when to put it back on.
- We will not be distributing worship bulletins, passing the offering plate, or passing the communion elements.
- Communion will be served by two volunteers that will wear gloves and face mask. The volunteers will go row by row and distribute the elements to each household group. Please take your cups with you as you exit the conference room and place them in the trash can provided at the door.
- Once worship is over, the ushers will dismiss attendees by row. You will exit the same way you entered. Please maintain safe distancing as you move outside.

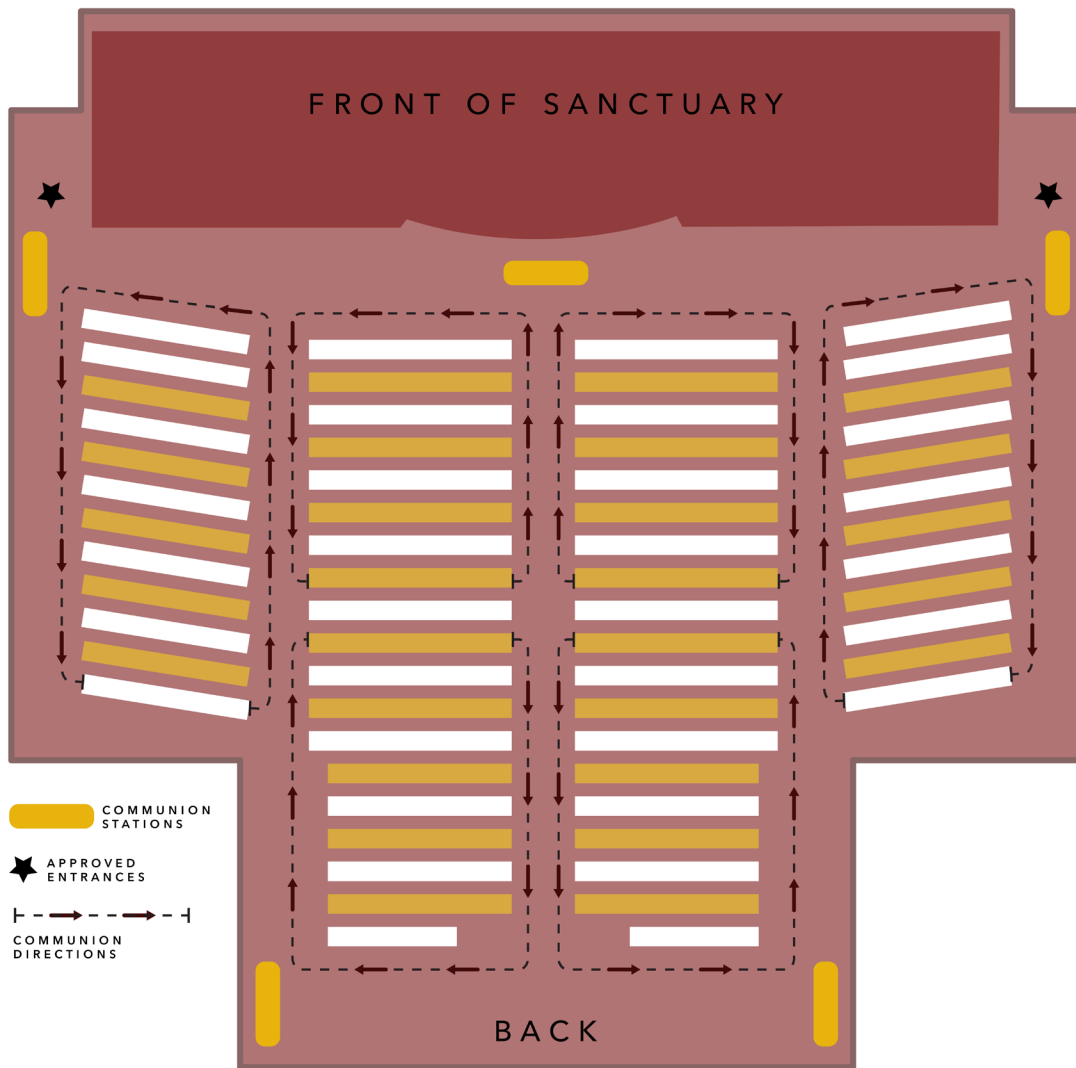

SEATING + COMMUNION FLOW CHART

The yellow pews will be where attendees are seated. Follow the arrows to the assigned communion station for that zone of the sanctuary. The stars are the approved entrances and exits for worship, you will be dismissed by row.